

## Mira 45 LT | 2 W | spot 12° | Wall recessed

Also available for floor recessed

### Technical Specifications

all the technical specifications are related to one head only

<b>Source lamp</b>	LED 2 W
<b>Total wattage</b>	2
<b>Voltage</b>	24 Vdc
<b>Control</b>	Power supply not included • dimmable on request
<b>Luminous flux (*Source flux)</b>	118 lm (160 lm*) @ 3000 K
<b>Luminous efficacy</b>	59 lm/W @ 3000 K
<b>McADAM steps</b>	3
<b>Beam</b>	spot 12°
<b>CRI</b>	>90
<b>Life time</b>	L 70 > 50.000 h Ta 25°C L 70 > 50.000 h Ta 40°C
<b>IP rating</b>	66
<b>IK rating</b>	6
<b>Insulation class</b>	III

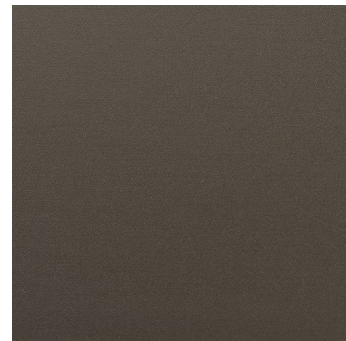
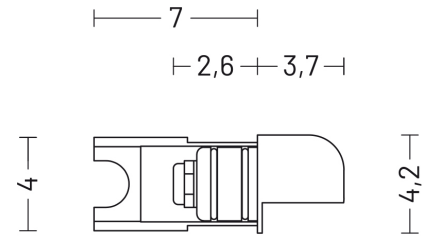

### Materials

<b>Body</b>	Extruded aluminium EN AW6060
<b>Diffuser</b>	Extra clear polycarbonate
<b>Finishing</b>	Bronze - Anodized

E (lux)

H (m)	lux (3000 K)	lux (4000 K)	Ø (m)
1.00	1136	1136	0.2
2.00	284	284	0.4
3.00	126	126	0.6
4.00	71	71	0.9
5.00	45	45	1.1

Photometry

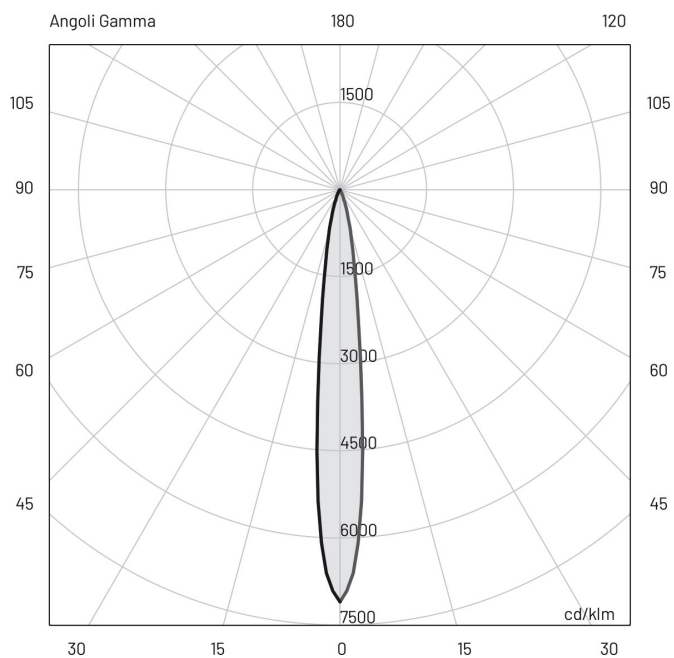

### Included accessories

- 1 m length cable -05RN-F
- Housing box

### Available accessories

- 0404M009** Single connection IP68  
Only for floor recessed
- 0409BT016** Transformer \_ 24 Vdc - 100 W  
Connect up to 30 devices
- 0409BT014** Transformer \_ 24 Vdc - 12 W  
Connect up to 4 devices
- 0409BT015** Transformer \_ 24 Vdc - 25 W  
Connect up to 8 devices